

# LAUNCH

DIESEL CLASS B MOTORHOME



2022

**LaMesa** REC  
VAN

LaMesaRV.com  
800-496-8778



**ENTEGRA**  
COACH®







# FLOORPLAN

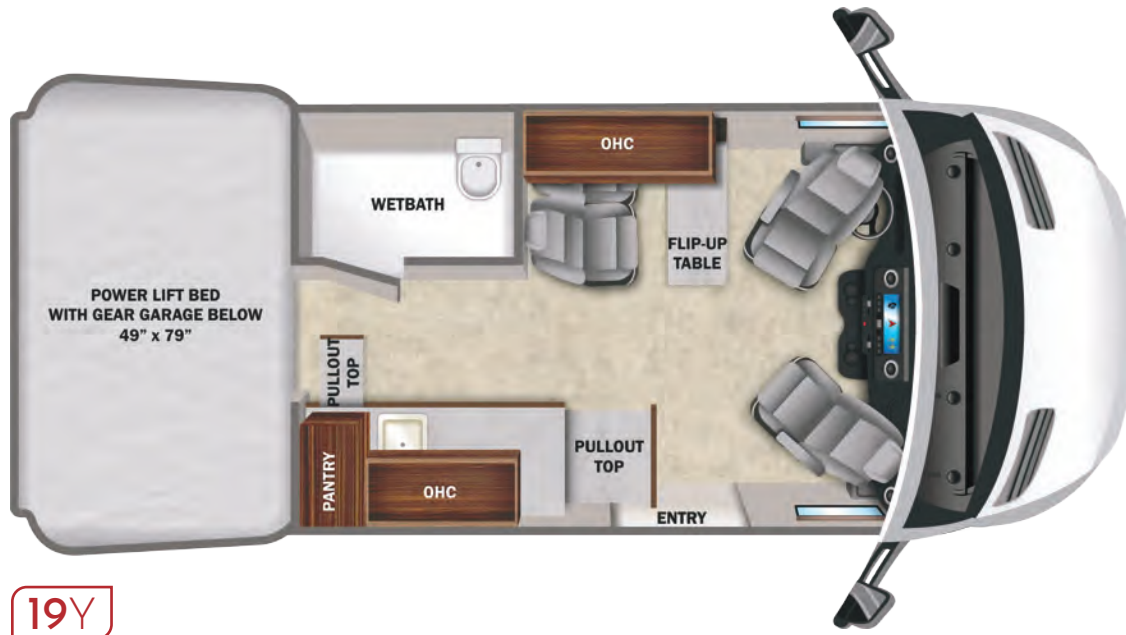

## EXTERIOR SELECTIONS



Standard Exterior (silver or sandstone)



Aztec Partial Paint (silver van only)



Forest Glade Partial Paint (sandstone van only)

## CUSTOMER VALUE PACKAGE

E-Z DRIVE™: Koni® shocks, heavy-duty rear stabilizer bar  
 Carefree armless patio awning with LED light strip and wind sensor  
 Double roof rack and moveable roof ladder  
 Front and rear wind deflectors with front LED light bar  
 Hydronic heating system with LED touchscreen control  
 48V Coleman®-Mach® 10 air conditioner  
 Black aluminum wheels with BFGoodrich® All-Terrain T/A® KO2® tires

## STANDARD CHASSIS EQUIPMENT

Mercedes-Benz® Sprinter 2500 4x4 van with 144-in. wheelbase  
 GVWR - 9,050 lb.  
 GCWR - 13,550 lb.  
 3.0L V6 engine with 188HP and 325 ft.-lb. torque  
 7-speed automatic transmission  
 220-amp alternator  
 Daytime running headlamps  
 Power folding/heated side-view mirrors  
 3,500-lb. rear hitch receiver with dual 4/7 pin connector  
 12V chassis battery  
 24.5-gal. fuel tank (diesel)  
 5.8-gal DEF Tank

## HEAT, A/C, POWER & WATER EQUIPMENT

48V - 210 amp hour smart lithium battery providing 10.2 KW hours of power  
 3500-watt inverter  
 2nd 48V alternator dedicated to lithium battery  
 30-amp electrical service with detachable power cord  
 200 watts of roof-mounted solar panels  
 Slow charge solar panel for chassis battery  
 Utility center with water controls and outside hose  
 Winterization drain system  
 12V demand water pump  
 Water filtration system  
 House battery disconnect switch  
 Aqua View® SHOWERMISER™ water management system  
 Heated grey tank (12V pad) with skid plate  
 Interior-mounted fresh water tank

## STANDARD EXTERIOR EQUIPMENT

LED-lit running boards for cab and entry doors  
 110V exterior outlet  
 Portable solar plug  
 LED-lit holding tank valves  
 Side screen door with magnetic and zipper close-offs  
 Rear screen door with roll-up and blackout capabilities  
 Fold-down exterior table  
 On-board air compressor with front and rear chucks

## COCKPIT AMENITIES

10.25-in. MBUX infotainment center  
 Power windows and door locks  
 A/C and adaptive cruise control  
 Active brake assist  
 Heated power swivel driver/passenger seats  
 Smartphone tray with wireless charging  
 Rain-sensing wiper system  
 Lane keeping assist  
 Blind spot assist  
 Traffic sign assist  
 Leather-wrapped tilt steering wheel with integrated controls  
 Cab area privacy shade  
 Remote keyless entry

## STANDARD INTERIOR EQUIPMENT

Custom-molded, vinyl-wrapped ABS interior wall panels  
 Soft-touch vinyl ceiling  
 High-intensity LED ceiling lights  
 Tecnoform® European-style cabinetry  
 Tecnoform® pull-out kitchen countertop extension  
 Pantry with Tecnoform® pull-out extension  
 Durable rubber flooring  
 Firefly Multiplex system  
 (2) sliding vented windows with cassette shades  
 Rear dual-pane acrylic window with cassette shades  
 MaxxAir Deluxe roof vent  
 (2) additional cab bucket seats with slide and recline features  
 BOSS® dual-zone radio with Bluetooth®  
 Collapsible dinette table  
 3-cu.ft. DC refrigerator

Portable induction cooktop  
 Stainless-steel sink  
 110V/USB outlets throughout  
 Drop-down overhead bed with 750-lb. capacity  
 Fiberglass side pods create larger sleeping surface  
 Rear garage under bed with L-track mounts for securing cargo  
 (2) recessed under-bed storage bags  
 RAM® Tough-Track™ mounts throughout  
 All-in-one wet bath with shower and cassette toilet  
 Removable bamboo shelves in wet bath  
 Powered roof vent in bathroom  
 Retractable clothes line in shower

## STANDARD SAFETY EQUIPMENT

Seatbelts at all designated seating locations  
 Driver and passenger airbags  
 Smoke alarm  
 Carbon monoxide detector  
 Fire extinguisher

## WARRANTY



At Entegra Coach, we build our RVs to handle every adventure, then back them with an outstanding warranty. Our 2-year limited warranty has you covered for 2 camping seasons. That's 730 days. For a copy of our 2-year limited warranty with complete terms and conditions, please contact your local Entegra Coach dealer.

Floorplan	GVWR (lbs.)	GCWR (lbs.)	Wheel Base	Overall Length	Exterior Height w/ A/C & Satellite	Exterior Width	Interior Height	Fresh Water Capacity (gal.)	Grey Waste Water Capacity (gal.)	Black Waste Water Capacity (gal.)
19Y	9,050	13,550	144"	19' 7"	10' 1"	85"	73"	22	20	4.75

It is important for your safety and enjoyment that you are aware of the weights and tow ratings of the RV you select. Consult a competent advisor for questions or advice. Whether you are new to RVing or a veteran, get a feel for the performance of your RV before heading out on the roadways. When you tow a vehicle with your RV, you must drive differently than when you drive a single vehicle. Practice hooking up, driving, backing up and braking in a safe environment or seek out professional instruction. Jayco affixes a weight label to each RV which lists weight information for that vehicle. Refer to that label to verify the vehicle will meet your requirements. Gross Vehicle Weight Rating (GVWR): The maximum permissible weight of the motorhome, including the Unloaded Vehicle Weight (UVW) plus passengers, personal items, all cargo, fluids, options and dealer-installed accessories. The GVWR is equal to or greater than the sum of the UVW and the Cargo Carrying Capacity. Gross Combined Weight Rating (GCWR): The maximum allowable combined weight of the motorhome used as a tow vehicle and the attached towed vehicle.